



28 Mountain Avenue Woonona, NSW



4



2



2

## Expansive Family Home

This beautifully appointed and expansive home is positioned on the high side of the street offering ocean views from every level. You will be immediately drawn to the ambiance and space this beautiful family home has to offer. Features include:-

**Price:**

\$945,000

- Multiple large light filled living areas
- Built-in Gas log fire in the hub of the home
- Open plan living
- Parents retreat with master bedroom offering a walk-in robe and ensuite with spa
- 3 additional bedrooms all with built in robes
- 2 spacious bathrooms and an extra WC
- Polished wooden flooring and tiles throughout
- Modern kitchen with stainless steel appliances

**Adam McMahon**

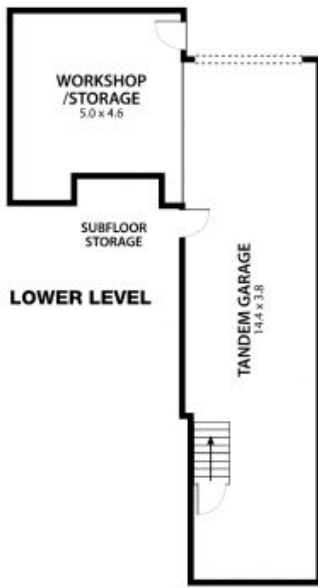

Plans shown are for presentation purposes and are not part of any legal document or title and are subject to errors, omissions, inaccuracies and should not be used as sole and accurate reference. Particulars given are for general information only and do not constitute any representation on the part of the vendor or agent. No liability will be accepted.