



6/392 Princes Highway Woonona, NSW



2



2



2

SLEEK TOWNHOUSE IN CONVENIENT LOCATION

Immaculate two level townhouse with north west sunlit aspect located in the heart of Woonona. Situated in a security complex with an alarm system and double security car space.

Features include:

- Two double sized bedrooms equipped with built-in wardrobes
- Generous open plan living and dining area with parkland views
- Sleek timber kitchen with black stone benches and splashback
- Kitchen boasts stainless steel appliances and built-in dishwasher
- Two modern spacious bathrooms
- Solid polished timber floorboards and split system air conditioning
- Spacious easy-care courtyard, ideal for alfresco entertaining
- A stones throw to local transport, cafes and schools with pristine beaches nearby.

Contact Dignam Real Estate on 4267 5377 or info@dignam.com.au to book your inspection time

Price: \$520 pw

Available Date: 2021-03-27

Sue English

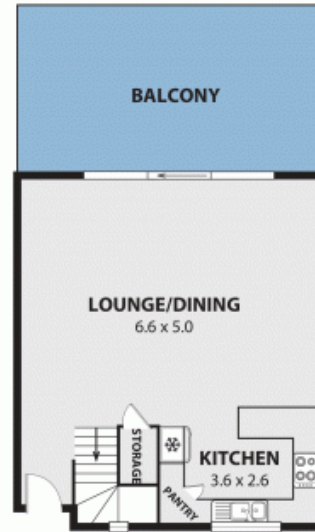
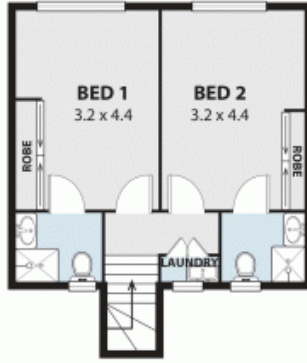

6/392 PRINCES HWY, WOONONA
Internal Space 88m²



Plans shown are for presentation purposes and are not part of any legal document or title and are subject to errors, omissions, inaccuracies and should not be used as sole and accurate reference. Particulars given are for general information only and do not constitute any representation on the part of the vendor or agent. No liability will be accepted. AR2.NET.AU

AR2