



4 Primbee Crescent Primbee, NSW



## LAKESIDE SUBURB HOME

Positioned within a tightly held enclave in the scenic lakeside suburb of Primbee is this comfortable family home. With rear lane access, what is truly special about this home, is the pristine waters of Lake Illawarra that beckon you, just a short walk away! Spend your weekends living the lakeside lifestyle: fishing, boating and kayaking with the family in the fresh air.

### Property Features:

- Three large bedrooms.
- Family sized bathroom with separate toilet.
- Functional kitchen flows seamlessly to the separate dining room.
- Spacious lounge room
- Ducted air-conditioning throughout.
- The oversized lock up garage underneath also offers multiple workshops and storage areas providing plenty of storage space for all the boy's toys!
- With rear lane access

**Price:** \$450

**Available Date:** 2019-06-28

**Rebecca Stephens**

0488117480

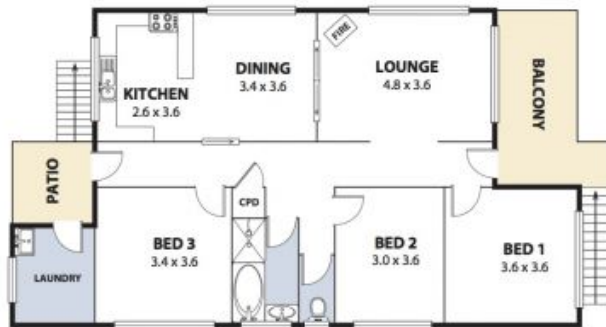
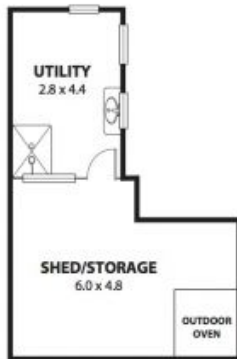
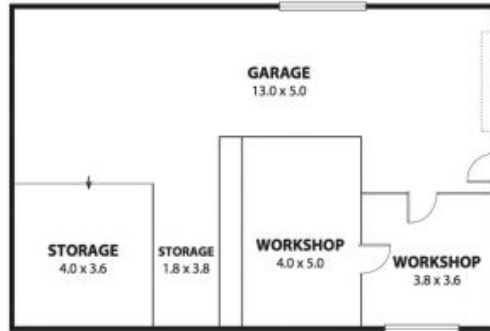
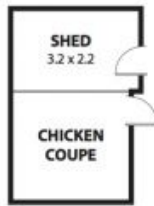

Plans shown are for presentation purposes and are not part of any legal document or title and are subject to errors, omissions, inaccuracies and should not be used as sole and accurate reference. Particulars given are for general information only and do not constitute any representation on the part of the vendor or agent. No liability will be accepted.