



5/4 Liddle Street Woonona, NSW

 2
  1
  1

## CONVENIENT COASTAL TOWNHOUSE WITH NEW KITCHEN

Tucked away in the exclusive "Ellesmere" estate, a rare opportunity to secure an entry level home or investment has presented itself to the market! An entertainer's dream, the home boasts a modern kitchen and private courtyard, perfect for those looking for a carefree coastal lifestyle home or investment property.

### Location

This small and quiet complex occupies an elevated position along a prestigious and highly sought-after Woonona pocket. Central to all the amenities that Woonona has to offer, a short walk will take you into the heart of the township where you'll find a thriving community filled with shops, supermarkets, services and loads of food and dining options.

For the avid surfer or for those that like a revitalizing swim in the ocean pool, the glistening sands and sparkling waters of Woonona Beach and Rock Pool are within a casual stroll

**Price:** \$565,000  
**Council Rates:** \$341.00 p/q  
**Water Rates:** \$226.00 p/q  
**Strata Rates:** \$445.00 p/q

**Adam McMahon**

**Adam McMahon**

02 4267 5377

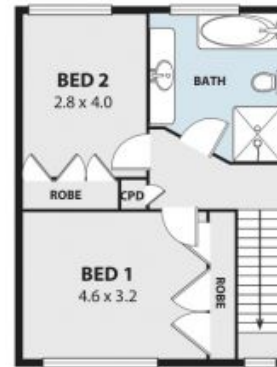

**3/4 LIDDLE ST, WOONONA**  
Internal Space 111m<sup>2</sup>



Plans shown are for presentation purposes and are not part of any legal document or title and are subject to errors, omissions, inaccuracies and should not be used as sole and accurate reference. Particulars given are for general information only and do not constitute any representation on the part of the vendor or agent. No liability will be accepted. AR2 METAU

AR2