



2/29 The Esplanade Thirroul, NSW



ENTRY-LEVEL APARTMENT 200M APPROX. TO THIRROUL BEACH

Dream of taking a stroll down to the beach for a morning walk? Or enjoying a lazy Sunday brunch in town? This second-floor apartment offers an amazing beach lifestyle, and it can be yours without having to compromise on the budget!

Price: \$730,000
Council Rates: \$419.00 p/q
Water Rates: \$175.00 p/q
Strata Rates: \$731.00 p/q

Location

Nestled in the perfect position, this well-presented unit resides in an enviable locale in the heart of Thirroul. Only 200m (approx) to the pristine shores of Thirroul Beach, here you'll find fantastic surfing conditions, an ocean pool and the Thirroul Surf Life Saving Club.

For those keen to explore the local parks and reserves, the Illawarra Cycleway is also accessible from your front door.

Serviced by bus links and a 5-minute walk to Thirroul Train Station, the home is only a 90

Adam McMahon

Adam McMahon

02 4267 5377

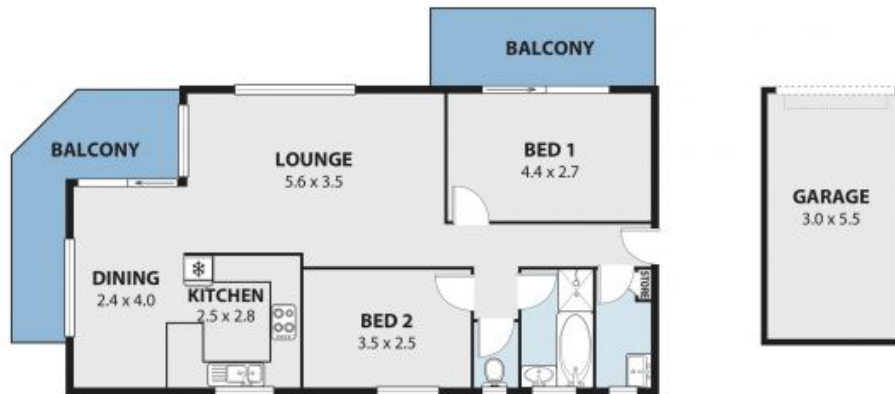

2/29 THE ESPLANADE, THIRROUL
 Internal Space 95m² (incl. garage)



Plans shown are for presentation purposes and are not part of any legal document or title and are subject to errors, omissions, inaccuracies and should not be used as sole and accurate reference. Particulars given are for general information only and do not constitute any representation on the part of the vendor or agent. No liability will be accepted. AR2, METAU

AR2