

10/29-31 Mercury Street Wollongong, NSW

 2  1  1

PRIME LOCATION TO INVEST OR START OUT!

Wake up every morning and appreciate a stunning, panoramic view of the escarpment from your private balcony! Enjoying a highly convenient position, this 2 bedroom unit is a short walk to Wollongong hubs and amenities.

Location

Situated in a popular complex, the property is less than a 200m walk from your new home to Wollongong's medical hub including the hospital. A further stroll down the road will take you into the vibrant Crown Street Mall where you can access major supermarkets and retailers, cinemas and a buzzing food and dining precinct.

Meander up the road for an afternoon jog or swim at Beaton Park Leisure Centre. Also in proximity is the University of Wollongong, the harbour, North Beach and various clubs.

Price: \$551,000
Council Rates: \$331.00 p/q
Water Rates: \$150.00 p/q
Strata Rates: \$797.00 p/q

Property
 Modern and spacious, th

Adam McMahon

Ethan Hennessy

02 4267 5377

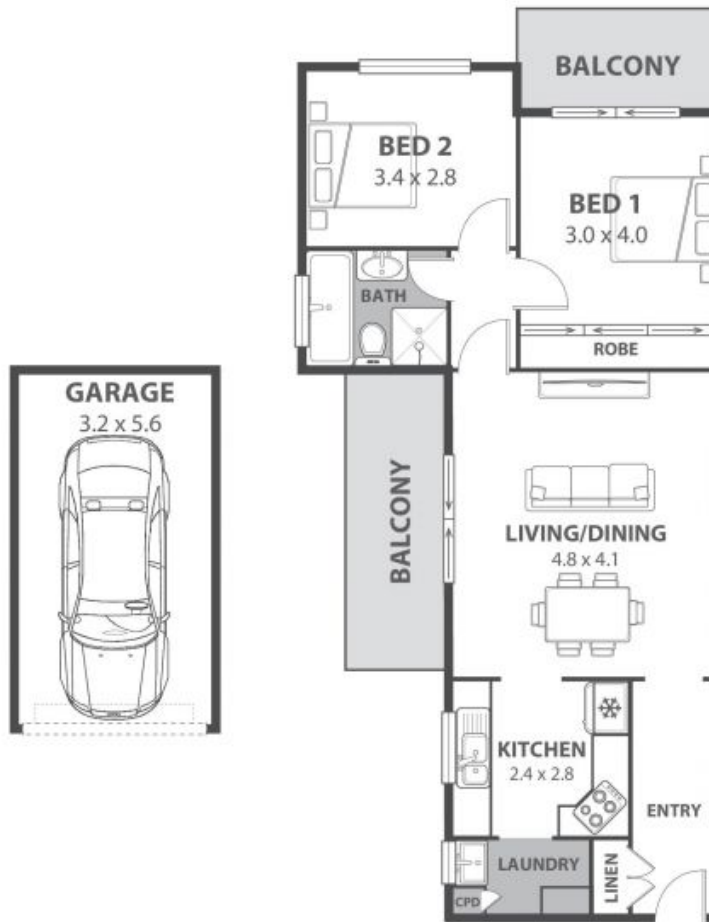

10/29 Mercury Street, Wollongong

Internal Space 99m²



Plans shown are for presentation purposes and are not part of any legal document in force and are subject to errors, omissions, inaccuracies and should not be used as sole and accurate reference. Particulars given are for general information only and do not constitute any representation on the part of the vendor or agent. No liability will be accepted.