



3/50 Squires Crescent Coledale, NSW



3



2



2

## BREATHTAKINGLY BEAUTIFUL BEACHSIDE LIVING

Breathtakingly beautiful and positioned only 200m (approx) to Coledale Beach, this magnificent tri-level terrace raises the benchmark in luxury coastal living.

### Location

Nestled perfectly between the pristine shorelines of Coledale Beach and the rolling greens of the Illawarra Escarpment awaits this spectacular home at the rear of a boutique complex. With the ocean visible at the end of the street, the waters beckon you for an early morning surf or swim before you start your day!

### Property

Architecturally designed and crafted to the highest of standards, this luxurious tri-level terrace seamlessly ble

**Price:** Contact Agent  
**Council Rates:** \$409.62/year (approx)  
**Strata Rates:** \$971.00 p/q

**Adam McMahon**

**Adam McMahon**

02 4267 5377

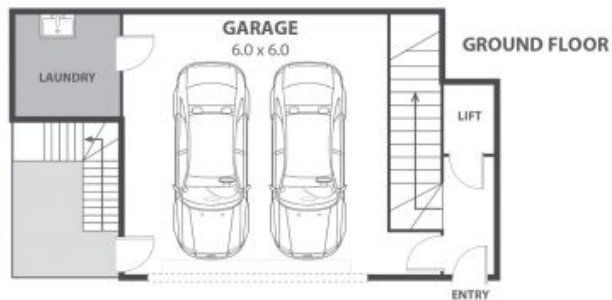

## 3/50 Squires Crescent, Coledale

Internal Space 191m<sup>2</sup>



Plans shown are for presentation purposes and are not part of any legal document at law and are subject to error, omissions, inaccuracies and should not be used as sole and accurate reference. Particulars given are for general information only and do not constitute any representation on the part of the vendor or agent. No liability will be accepted.