



6/738-744 Lawrence Hargrave Drive Coledale, NSW



3



2



2

## MODERN & SPACIOUS WITH OCEAN & ESCARPMENT VIEWS!

Filled with light and incredibly spacious, this tri-level townhouse is an updated property resting just footsteps to Coledale Beach and the village making this an excellent first home or investment opportunity.

### Location

Perfectly placed at the rear of a sought-after complex, this magnificent property appreciates only one adjoining neighbour and backs onto a council greenspace for the ultimate in privacy.

Coledale Public School and the local surf life saving club is a stroll up the road, and the area is well serviced by bus links and the Coledale Station which are both located within walking distance.

### Property

Superbly renovated and inspiring, this solid brick townhouse spills over 3 levels. Your joy

**Price:** \$1,400,000

**Council Rates:** \$425.00 p/q

**Water Rates:** \$150.00 p/q

**Strata Rates:** \$470.00 p/q

**Adam McMahon**

**Ethan Hennessy**

02 4267 5377

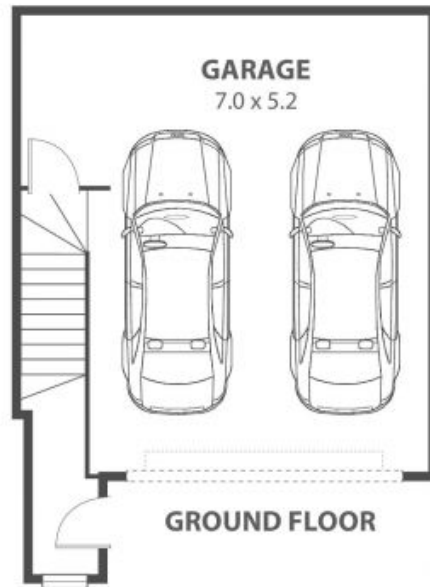
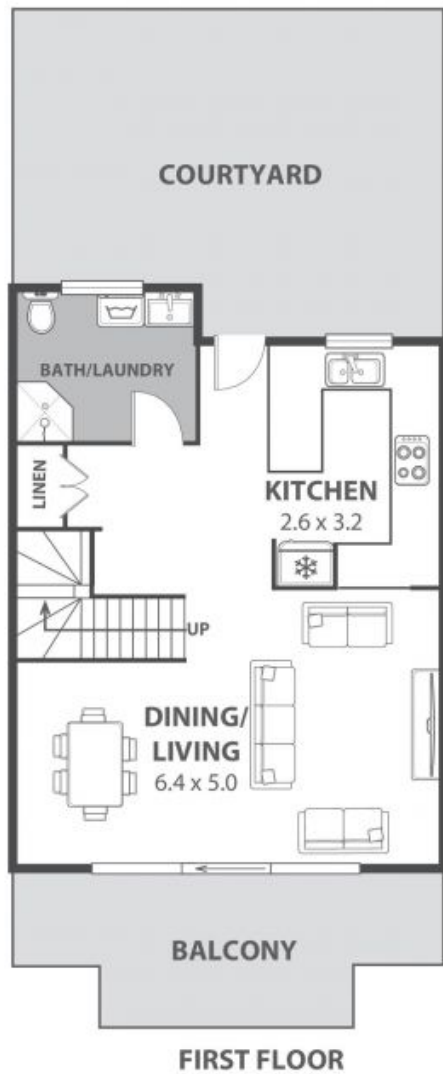

**6/738 Lawrence Hargrave Drive, Coledale**

Internal Space 154m<sup>2</sup>



Plans shown are for presentation purposes and are not part of any legal document in title and are subject to errors, omissions, inaccuracies and should not be used as sole and accurate reference. Particulars given are for general information only and do not constitute any representation on the part of the vendor or agent. No liability will be accepted.