



29 Whiting Crescent Corrimal, NSW



3



1



1

## A quiet family retreat + a fabulous coastal lifestyle

Ideally positioned for family life in a quiet pocket of sought-after Corrimal, this three-bedroom home offers comfort, flexibility, and a fantastic lifestyle location close to beaches, schools, and shops. Set on a generous block with beautiful established gardens, families and renovators will be excited by the potential this home presents.

### Location

Enjoying a peaceful location and views of the escarpment on the horizon, this home offers an ideal spot for families seeking a convenient coastal lifestyle.

Just 11 minutes (approx.) from the bustling CBD of Wollongong, and only a three-minute drive (approx.) to Corrimal's thriving shopping precinct, every convenience is only moments away.

...

Drive to Sydney in 74 minutes (approx.) or catch the train from Corrimal or Bellambi, with both stations conveniently positioned within five minutes of home....

...

Property...

For sale for the first

**Price:** \$975,200

**Council Rates:** \$485.25 p/q

**Adam McMahon**

**Adam McMahon**

02 4267 5377

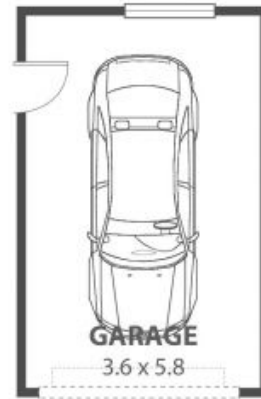
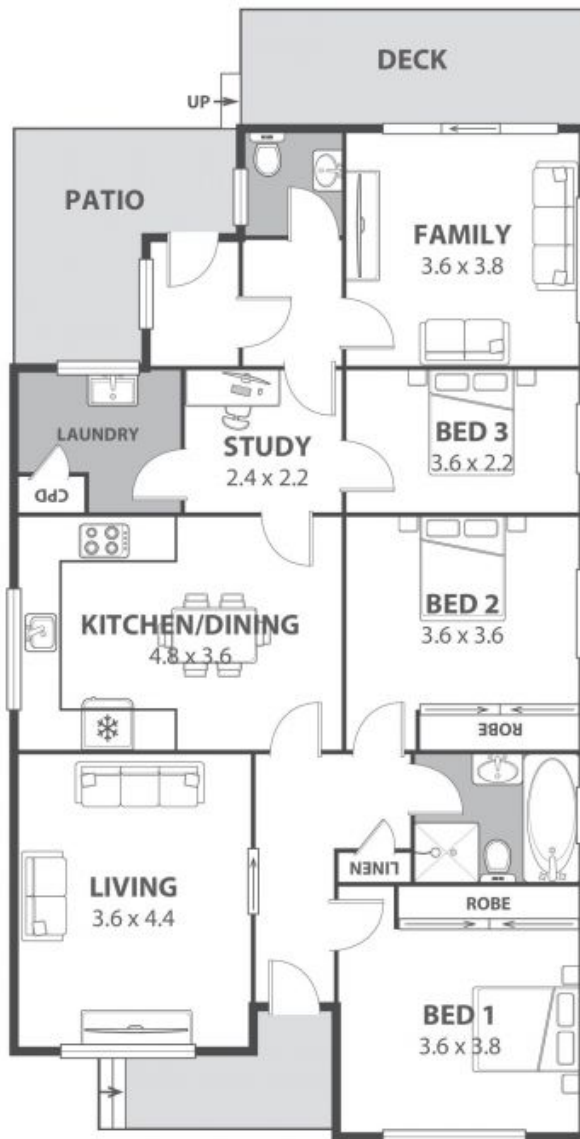

## 29 Whiting Crescent, Corrimal

Internal Space 139m<sup>2</sup>



Plans shown are for presentation purposes and are not part of any legal document in force and are subject to errors, omissions, inaccuracies and should not be used as sole and accurate reference. Particulars given are for general information only and do not constitute any representation on the part of the vendor or agent. No liability will be accepted.