

33 Brotheridge Avenue Calderwood, NSW



## Sleek and spacious family living in sought-after Calderwood Estate

Located in the sought-after Calderwood Estate, this stunning four-bedroom home showcases sleek cohesive design and a split-level floor plan perfect for family living. Situated minutes from cafes, schools, and public transport, and only a short drive to Shellharbour, this home will appeal to discerning families and astute investors alike.

**Price:** \$950,000

**Council Rates:** \$491.12 p/q

### Location

A family-friendly neighbourhood, peaceful living, and enviable convenience await in this ideal location within the popular Calderwood Estate. With the beautiful Bush-Themed Playground just 200m from your front door (approx.), the kids will love living here, while you'll covet the proximity to shops, schools, childcare, and amenities.

...

...

Property...

Showcasing an impressive commitment to design continuity and high-quality finishes, this i

**Ethan Hennessy**

**Adam McMahon**

02 4267 5377

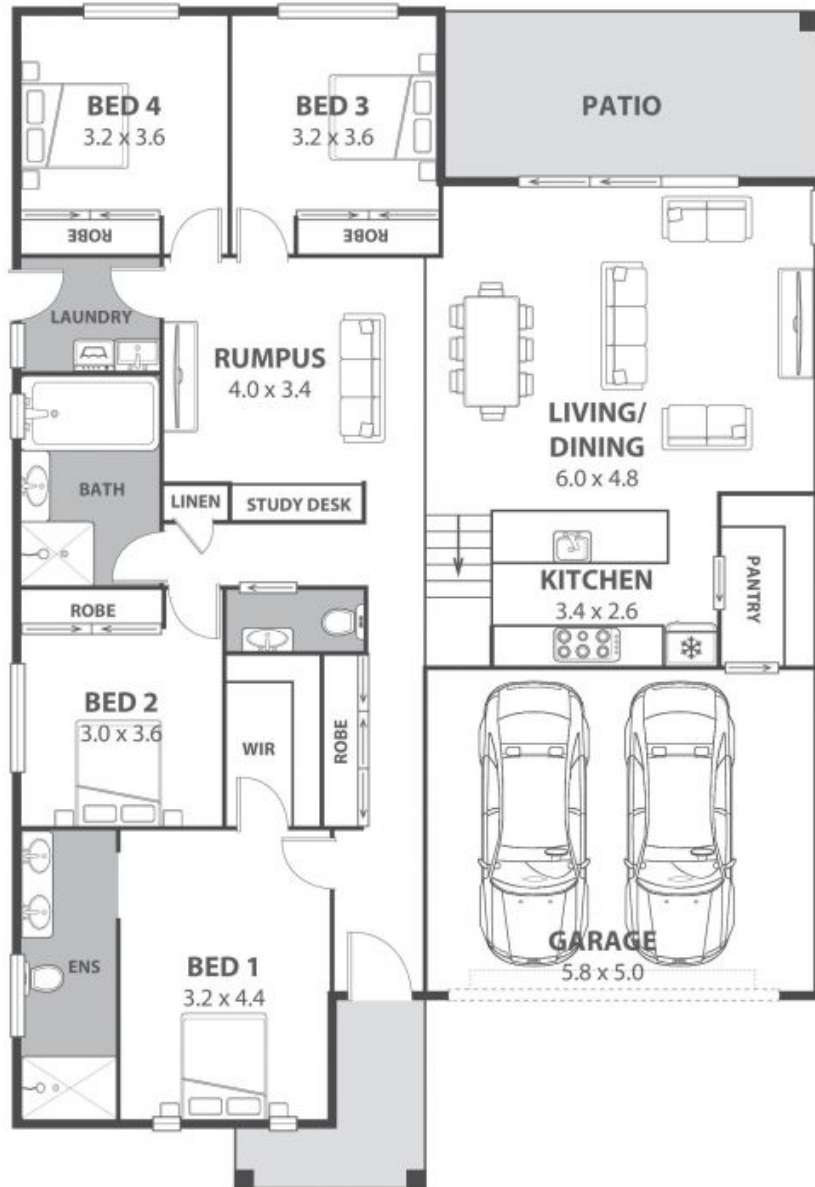

## 33 Brotheridge Avenue, Calderwood

Internal Space 177m<sup>2</sup>



Plans shown are for presentation purposes and are not part of any legal document in force and are subject to errors, omissions, inaccuracies and should not be used as sole and accurate reference. Particulars given are for general information only and do not constitute any representation on the part of the vendor or agent. No liability will be accepted.