

21 Summit Street Kembla Grange, NSW



4



2



2

## Easy family living with style and space in spades!

Boasting a prime position within the sought-after Sanctuary Views Estate, this four-bedroom, two-bathroom home will delight families seeking a home with room to grow. With a beautiful parkland outlook and every convenience just moments away, this is a fabulous opportunity to secure a near-new family home in a fabulous lifestyle location.

### Location

With an expanse of lush parkland across the street providing an ideal outlook and every convenience within easy reach, tranquil family living awaits in this picturesque location within the Sanctuary Views Estate.

...

Commuting to Sydney will take just 90 minutes (approx.), while nearby Wollongong provides big-city conveniences just 16 minutes from home (approx.). ...

...

### Property...

With four bedrooms, two living spaces, and superb outdoor entertaining, this near-new home is perfect for growing

**Price:** \$980,000

**Council Rates:** \$391.73 p/q

**Ethan Hennessy**

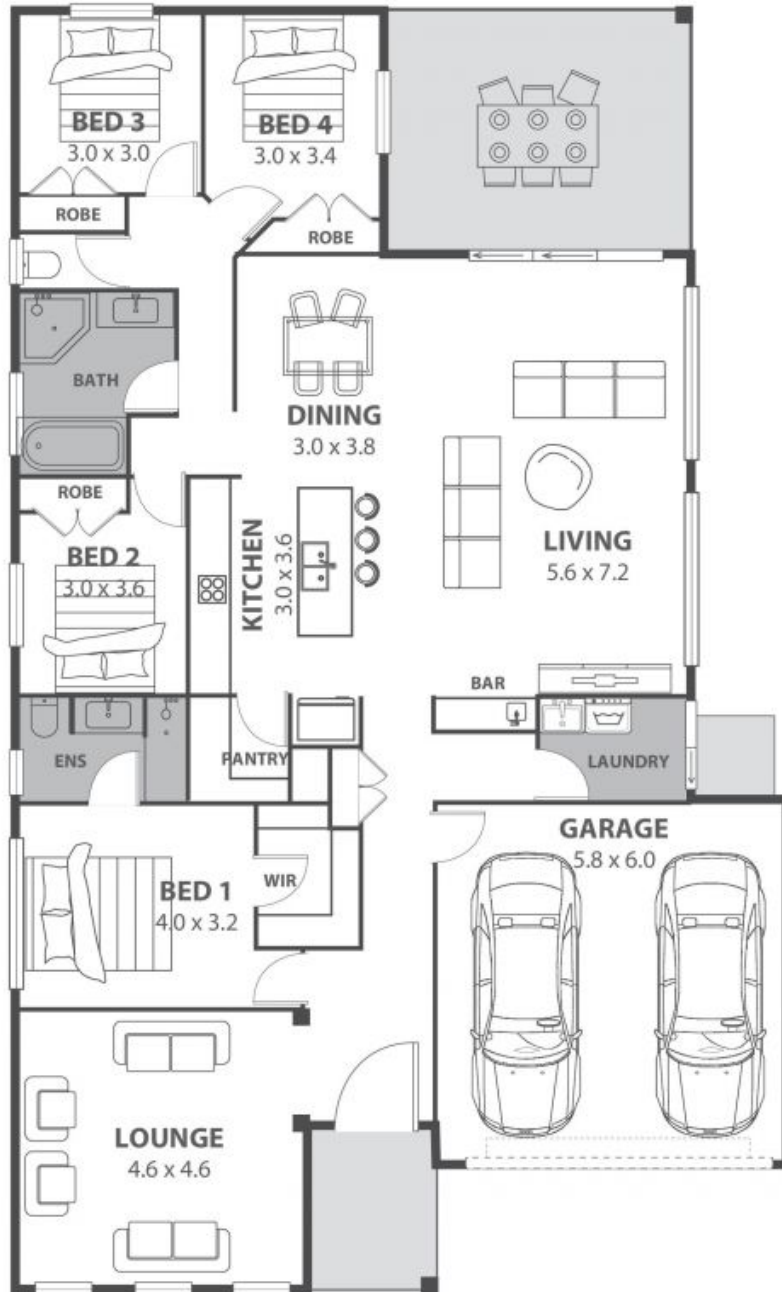

## 21 Summit Street, Kembla Grange

Internal Space 202m<sup>2</sup>



Plans shown are for presentation purposes and are not part of any legal document in force and are subject to errors, omissions, inaccuracies and should not be used as sole and accurate reference. Particulars given are for general information only and do not constitute any representation on the part of the vendor or agent. No liability will be accepted.