



14 Clayton Close Kembla Grange, NSW



4



2



2

Come home to tranquil family living in Kembla Grange

Ideally positioned in a quiet cul de sac, this inviting family home promises peaceful family living just moments from the conveniences of Dapto and less than 20 minutes from Wollongong (approx.). Sprawled over a single level, the floor plan has been mindfully designed for family life, with four spacious bedrooms, multiple living areas, and superb outdoor entertaining.

LOCATION

Families seeking a tranquil lifestyle and a family-friendly community will be delighted by this peaceful cul de sac address, with Sheaffes Creek's surrounding bushland just metres from home and every convenience close by.

...

...

...

PROPERTY...

...

A spacious single-level

Price: \$910,000

Council Rates: \$363.87 p/q

Ethan Hennessy

Isabelle Lace

02 4267 5377

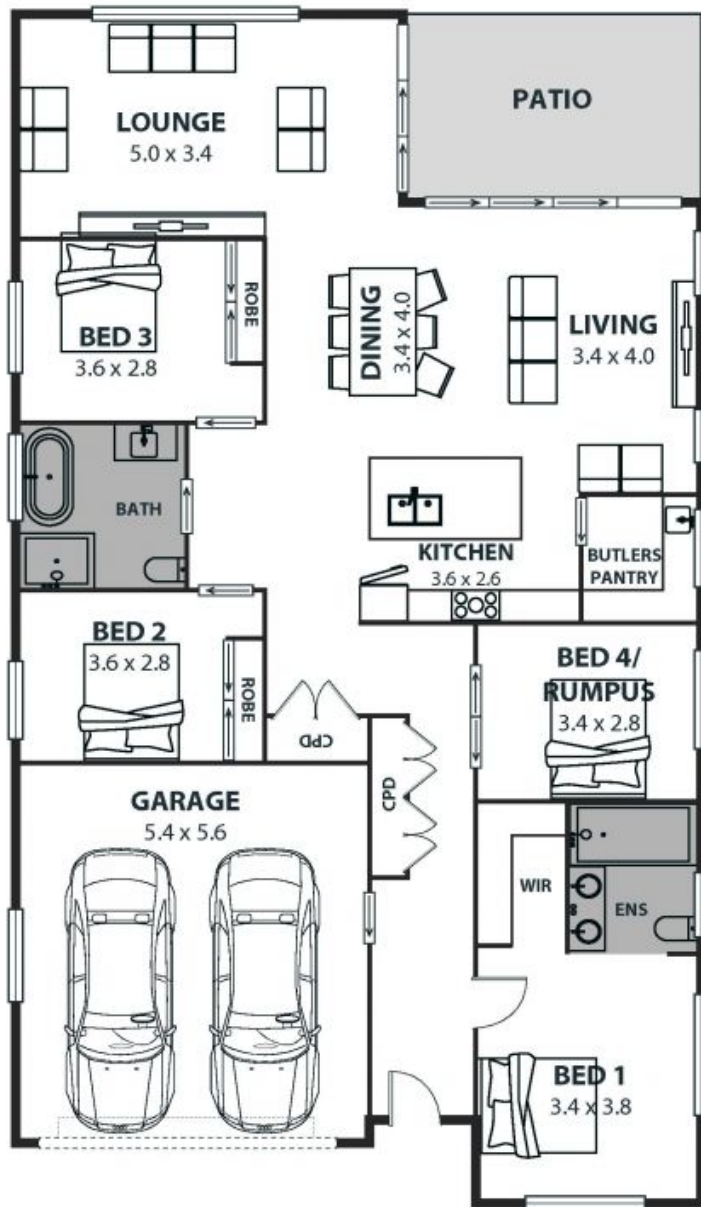

14 Clayton Close, Kembla Grange

Internal Space 237m²



Plans shown are for presentation purposes and are not part of any legal document or offer and are subject to errors, omissions, inaccuracies and should not be used as sole and accurate reference. Particulars given are for general information only and do not constitute any representation on the part of the vendor or agent. No liability will be accepted.