



50 Yates Avenue Mount Keira, NSW



6



3



3

Spacious family living at the foot of Mount Keira

Set on a generous allotment at the foot of Mount Keira, this sprawling six-bedroom, three-bathroom home offers super-spacious family living in a stunning location just moments from the heart of Wollongong's bustling CBD.

Price: \$1,130,000

Multiple living spaces are complemented by mountain-view balconies and a large back garden, setting the scene for the peaceful lifestyle you've been dreaming of.

LOCATION

Enjoy tranquil family living in this ideal location, where mountain views provide the perfect backdrop for daily life and big-city conveniences await just moments from home.

Drive into Wollongong's city centre in just eight minutes (approx.) to enjoy fabulous shopping and endless dining and entertainment options.

The choice of local parks and playgrounds within walking distance is sure to delight the kids, while Wollongong's stunning city beaches await just ten minutes from home (approx.) ensuring a fabulous coas

Ethan Hennessy

Shawn Condello

02 4267 5377

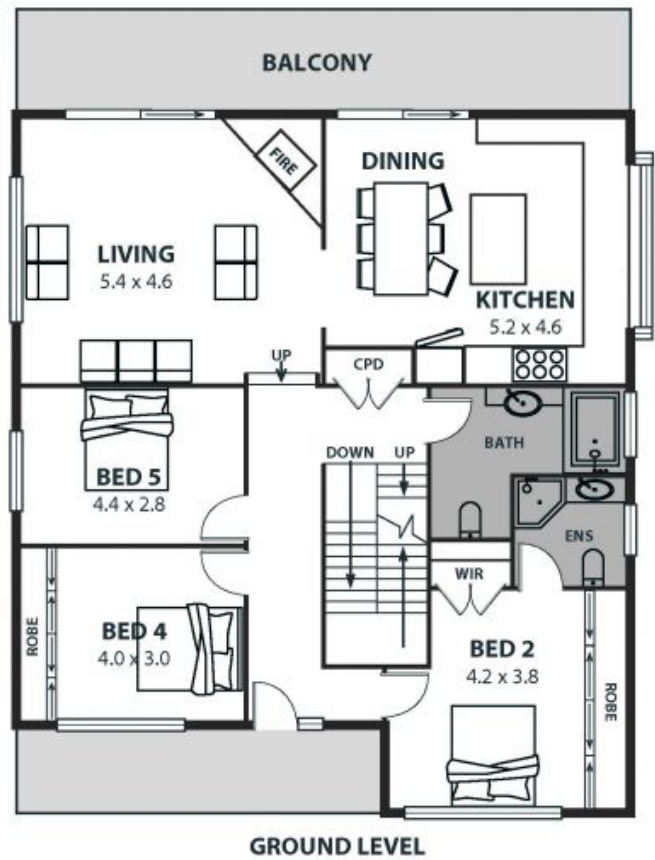
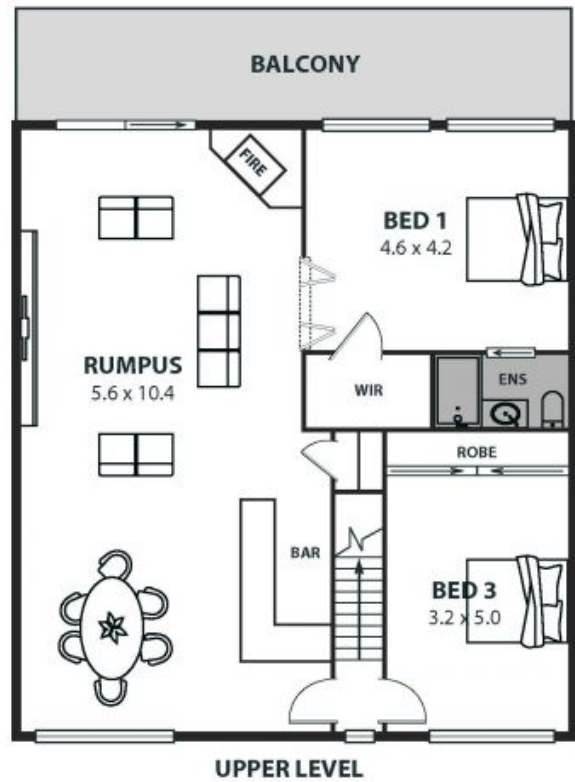
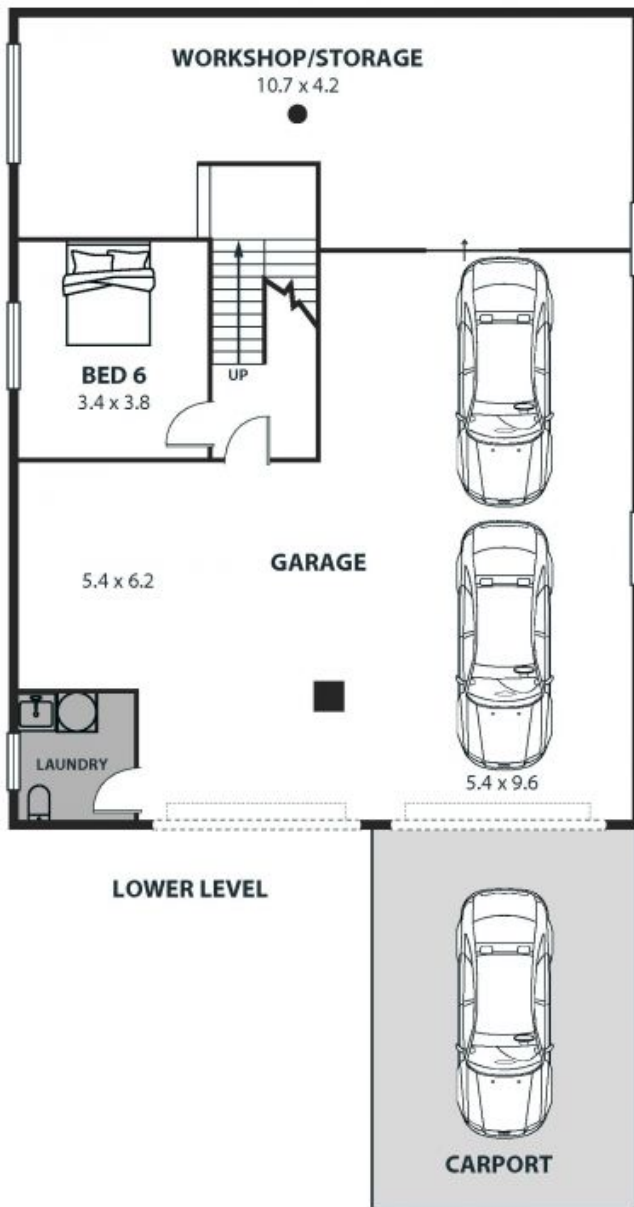

50 Yates Avenue, Mount Keira

Internal Space 375m²



Plans shown are for presentation purposes and are not part of any legal document or offer and are subject to errors, omissions, inaccuracies and should not be used as sole and accurate reference. Particulars given are for general information only and do not constitute any representation on the part of the vendor or agent. No liability will be accepted.