

1/10 Hobart Street Bulli, NSW

 4
  1
  2

Family living in a superb walk-to-the-village location!

Families seeking the famed Bulli lifestyle will be delighted by this four-bedroom duplex embraced by stunning parkland and only moments from some of the region's most beautiful beaches. Walking distance to Bulli Village adds extra appeal to this move-in-ready home, perfect for home buyers and investors alike.

Price:

Contact Agent

Location

Easy coastal living awaits in this fabulous Bulli location, where surrounding parkland creates a tranquil setting and moments-from-home access to shops and schools ensures enviable convenience.

...
 Drive to Sydney in just over an hour (approx.) or walk to Bulli Station for regular city-bound trains. ...

Adam McMahon

Adam McMahon

02 4267 5377

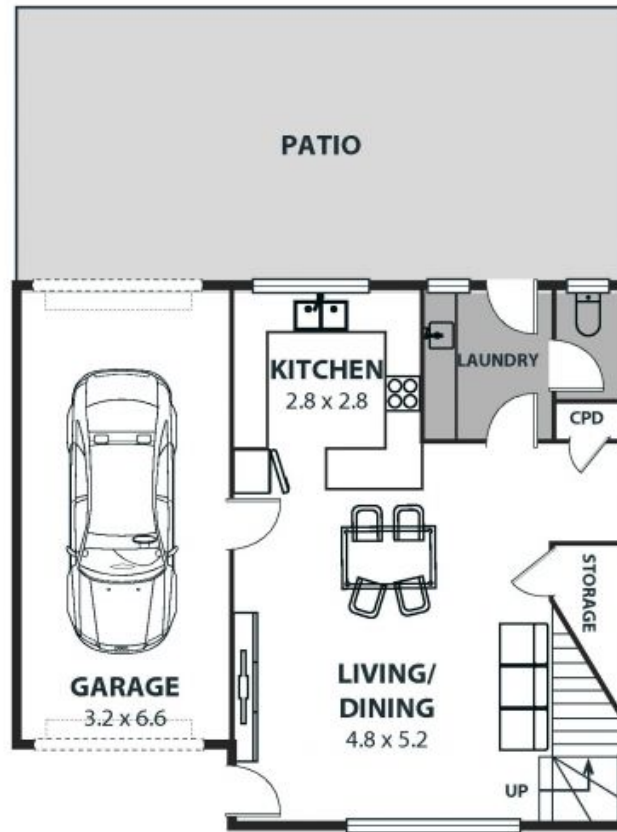
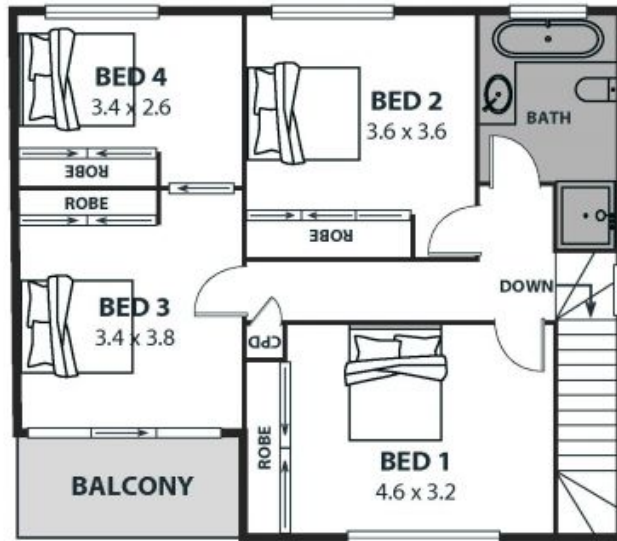

1/10 Hobart Street, Bulli

Internal Space 146m²



Plans shown are for presentation purposes and are not part of any legal document or title and are subject to error, omissions, inaccuracies and should not be used as sole and accurate reference. Particulars given are for general information only and do not constitute any representation on the part of the vendor or agent. No liability will be accepted.