

6/145 Campbell Street Woonona, NSW



3



2



2

## Coastal Entertainer!

Nestled within a boutique complex of just eight homes, this beautifully presented townhouse offers light-filled modern living and easy alfresco entertaining sure to impress families, couples, and investors alike.

Just a short walk from the village and only moments from some of the region's most stunning beaches, this is a lifestyle proposition too good to miss!

### LOCATION

Buyers seeking convenience, enviable beach access, and proximity to the city will be delighted by the lifestyle benefits of this ideal address, tucked in a peaceful pocket of Woonona where stunning mountain views offer the perfect backdrop.

Walk to Woonona Village in three minutes to enjoy its great selection of cafes, eateries, shops, and services including walking distance to the local IGA and fresh food grocery stores. Bulli Village and Woolworths await a four-minute drive from home, while just 11 minutes away, Wollongong's b

**Price:** Price Guide \$1,100,000

**Council Rates:** \$427.77 p/q

**Strata Rates:** \$400.00 p/q

**Ethan Hennessy**

**Adam McMahon**

02 4267 5377

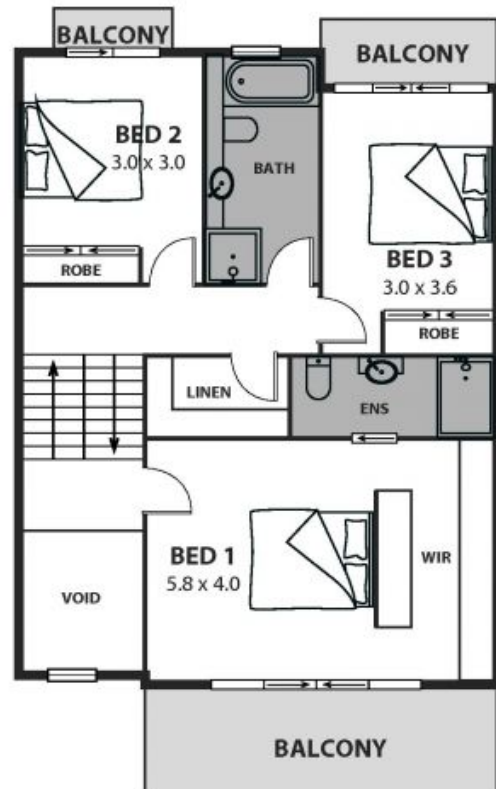
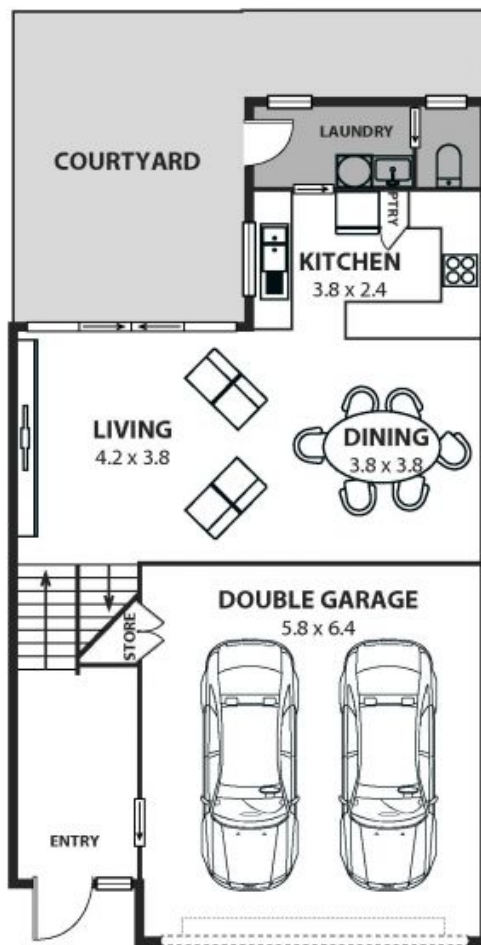

**6/145-147 Campbell Street, Woonona**

Internal Space 147m<sup>2</sup>



Plans shown are for presentation purposes and are not part of any legal document or title and are subject to errors, omissions, inaccuracies and should not be used as sole and accurate reference. Particulars given are for general information only and do not constitute any representation on the part of the vendor or agent. No liability will be accepted.