



5 Mary Callaghan Crescent Woonona, NSW



4



2



2

## Spacious family living with room to grow!

Set on 693 sqm (approx.) in a sought-after walk-to-the-beach location, this much-loved four-bedroom family home offers spacious, move-in-ready interiors and a huge back garden sure to delight growing families.

With scope for modern updates and plenty of room to extend (STCA), the potential here is endless!

### Location

With beaches, sought-after schools, and every convenience within enviably easy reach, this coveted address offers a superb coastal lifestyle.

Walk to Bellambi Lane Cafe to start the day with a great coffee, stroll to local shops and services, and finish the day with a family meal at the beautiful Bellambi Hotel, an easy walk from home. Six minutes (approx.) away Corrimal's vibrant shopping precinct awaits, while Wollongong's CBD is only 11 minutes from home, ensuring your relaxed beach lifestyle doesn't come at the expense

**Price:** \$1,850,000

**Adam McMahon**

**Ange Carrigan**

02 4267 5377

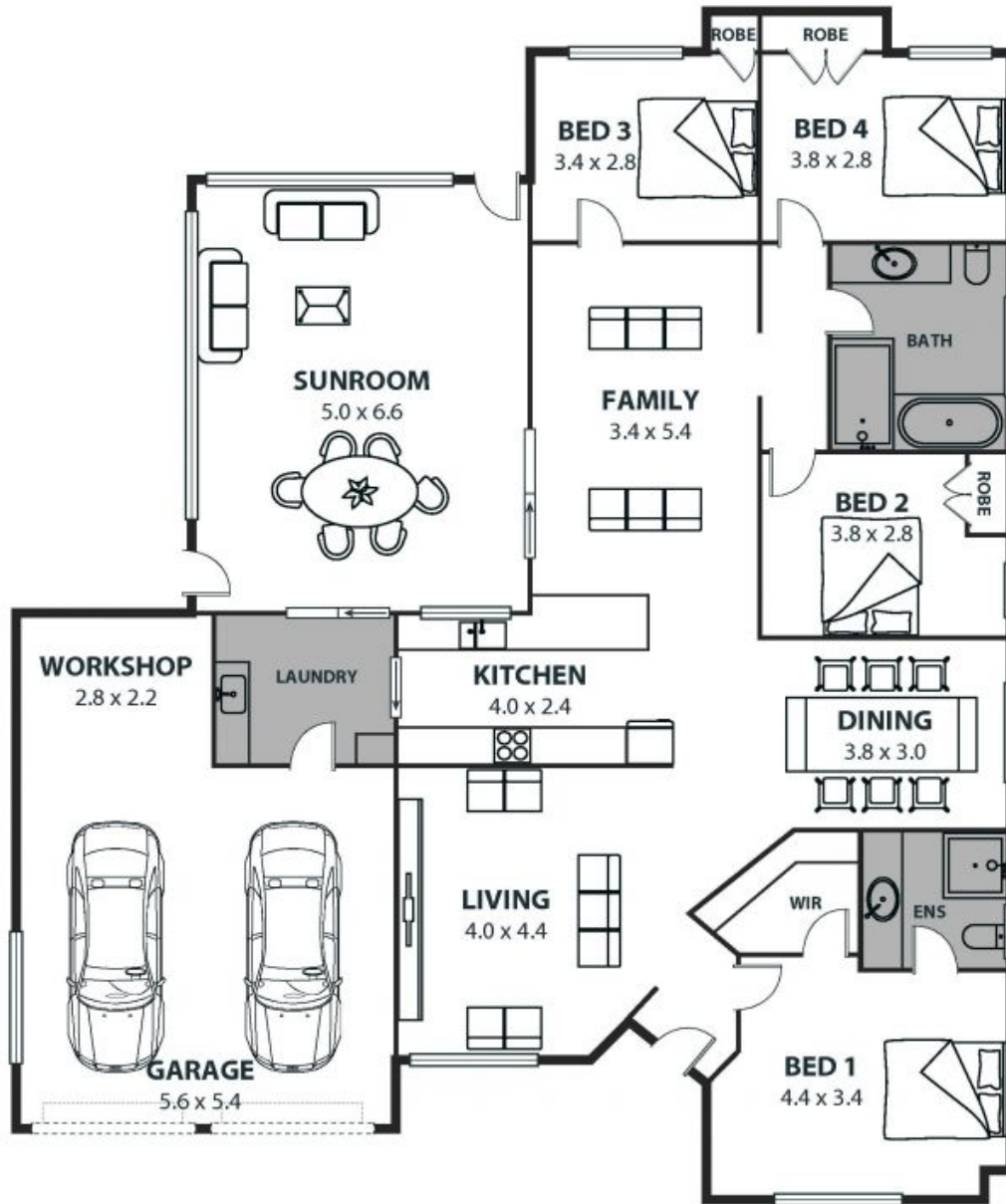

## 5 Mary Callaghan Crescent, Woonona

Internal Space 207m<sup>2</sup>



Plans shown are for presentation purposes and are not part of any legal document or title and are subject to errors, omissions, inaccuracies and should not be used as sole and accurate reference. Particulars given are for general information only and do not constitute any representation on the part of the vendor or agent. No liability will be accepted.