



227 Princes Highway Bulli, NSW



3



2

## PICTURE-PERFECT FEDERATION-STYLE HOME

Behind the quintessential picket fence lies a stunning federation-style cottage adorned with all the classic trimmings. This property enjoys an ultra-convenient location to the buzzing Bulli town centre offering a wide range of cafes, restaurants and eateries as well as services. Also a casual stroll down Park Road will have you arrive at the ever popular Sandon Point Beach, passing beautiful Bulli Park along the way!

Features include:

- Three large bedrooms
- Family bathroom and additional bathroom facilities in combined laundry
- Stylish updated kitchen boasts plentiful storage, a chef's grade oven and gas cooktop, glass splashbacks and a sparkling stone benchtop.
- Timber and glass french doors flood the living spaces in abundant natural light and open onto the partially covered back patio.
- Ceiling fans, high ceilings and timber floors throughout
- Sizeable grassy lawn with timber deck
- Positioned around the corner from Bulli Train Station while the highway is readily accessible. A trip to Sydney CBD will take approximately 90-minutes and Wollongong can be reached in under 20-minutes

**Price:** \$750 pw

**Available Date:** 2024-04-26

**Dignam Real Estate**

**Property Management**

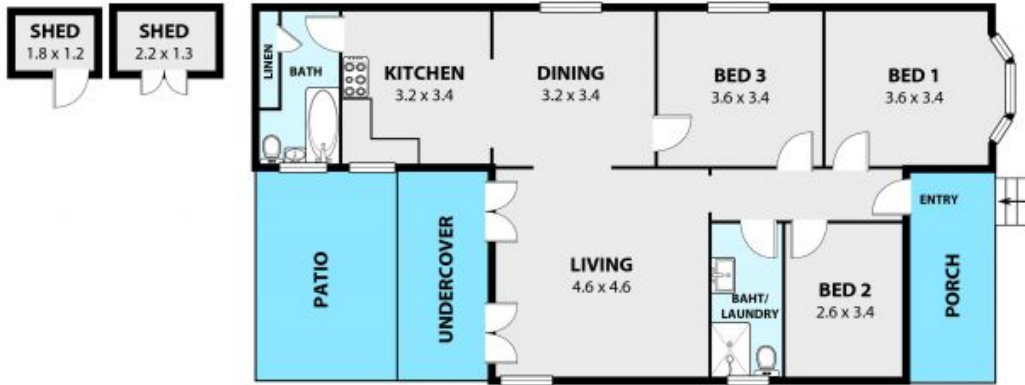

227 PRINCES HIGHWAY, BULLI  
Internal Space 96m<sup>2</sup>



Plans shown are for presentation purposes and are not part of any legal document or title and are subject to errors, omissions, inaccuracies and should not be used as sole and accurate reference. Particulars given are for general information only and do not constitute any representation on the part of the vendor or agent. Its liability will be accepted. AR2,NET,ND

AR2