



2 Pinnacle Way Koonawarra, NSW



3



2



2

## The 'Pinnacle' of Family Living ? at 2 Pinnacle Way!

Welcome to this stunning two-story brick home, a standout residence in Koonawarra's sought-after enclave surrounded by other newly built, high-quality homes. With its striking street presence, this property combines a timeless brick facade with simple, refined landscaping, creating an inviting and sophisticated first impression.

**Price:**

\$795,000

### PROPERTY HIGHLIGHTS:

? **Striking First Impression:** From the moment you arrive, this home's timeless brick exterior and manicured landscaping make a powerful statement. A generously sized driveway offers ample off-street parking, making it as practical as it is beautiful.

? **Bright & Breezy Interiors:** Step inside to find sun-drenched rooms complemented by a modern, neutral colour scheme, warm oak flooring, and ducted air conditioning, ensuring comfort and style all year long.

? **Modern Kitchen:** At the heart of this home, the contemporary kitchen is designed to impress, with abundant storage, a large oven and cooktop, and a breakfast bar ready for everything from quick morning

**Ethan Hennessy**

**Shawn Condello**

02 4267 5377

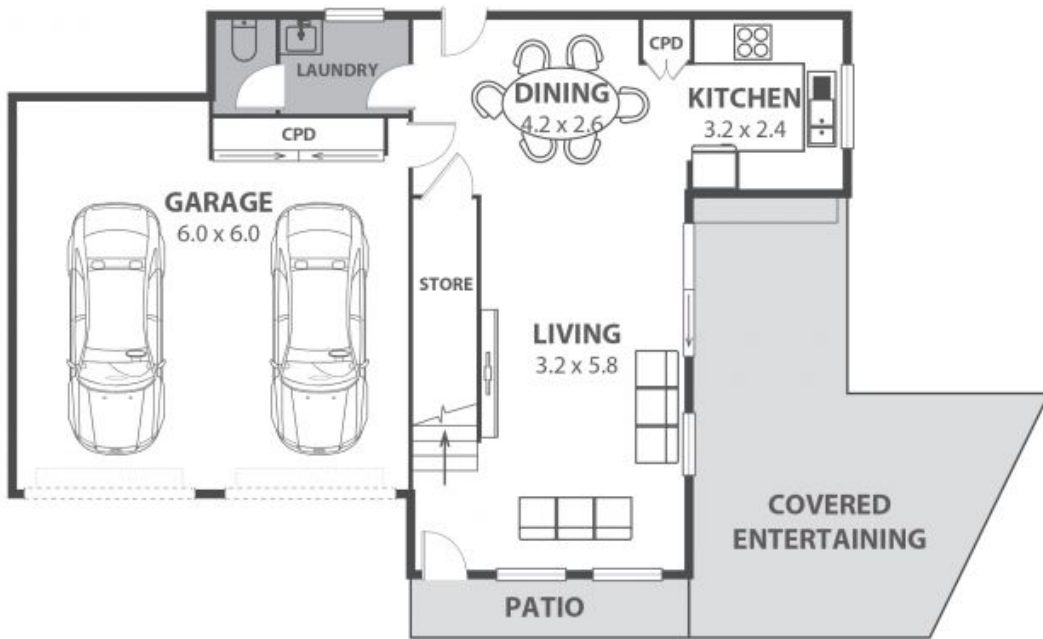
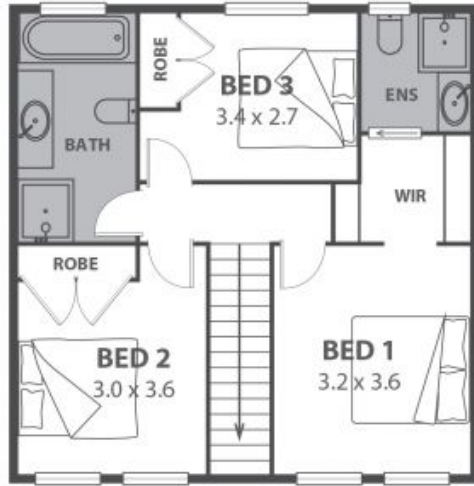

## 2 Pinnacle Way, Koonawarra

Internal Space 130m<sup>2</sup>



Plans shown are for presentation purposes and are not part of any legal document as they are subject to errors, omissions, inaccuracies and should not be used as sole and accurate reference. Particulars given are for general information only and do not constitute any representation on the part of the vendor or agent. No liability will be accepted.