



38 Buttenshaw Place Austinmer, NSW

 3

 1

 2

## CHARMING ORIGINAL COTTAGE IN AN EXCLUSIVE ESCARPMENT ENCLAVE

Nestled on the foothills of the escarpment and set within an exclusive cul-de-sac, this original cottage offers a whimsical coastal lifestyle surrounded by nature and close to beaches. Comfortable to move in as is, there's also endless scope to extend or renovate if desired.

**Price:**

Contact Agent

### PROPERTY HIGHLIGHTS:

**Classic Charm:** Exceptionally well-maintained, the original interiors of the home showcase classic features including high ceilings and decorative cornices. Framing the property is a quintessential picket fence which encompasses the sunny, north-facing frontage.

**Lush Gardens:** Occupying a sprawling 784m<sup>2</sup> (approx) allotment, the lush lawn and native gardens provide a wonderful place for children to play safely outside and adults to relax. Discover the local wildlife and immerse yourself in the unparalleled tranquility that only e

**Adam McMahon**

**Ange Carrigan**

02 4267 5377

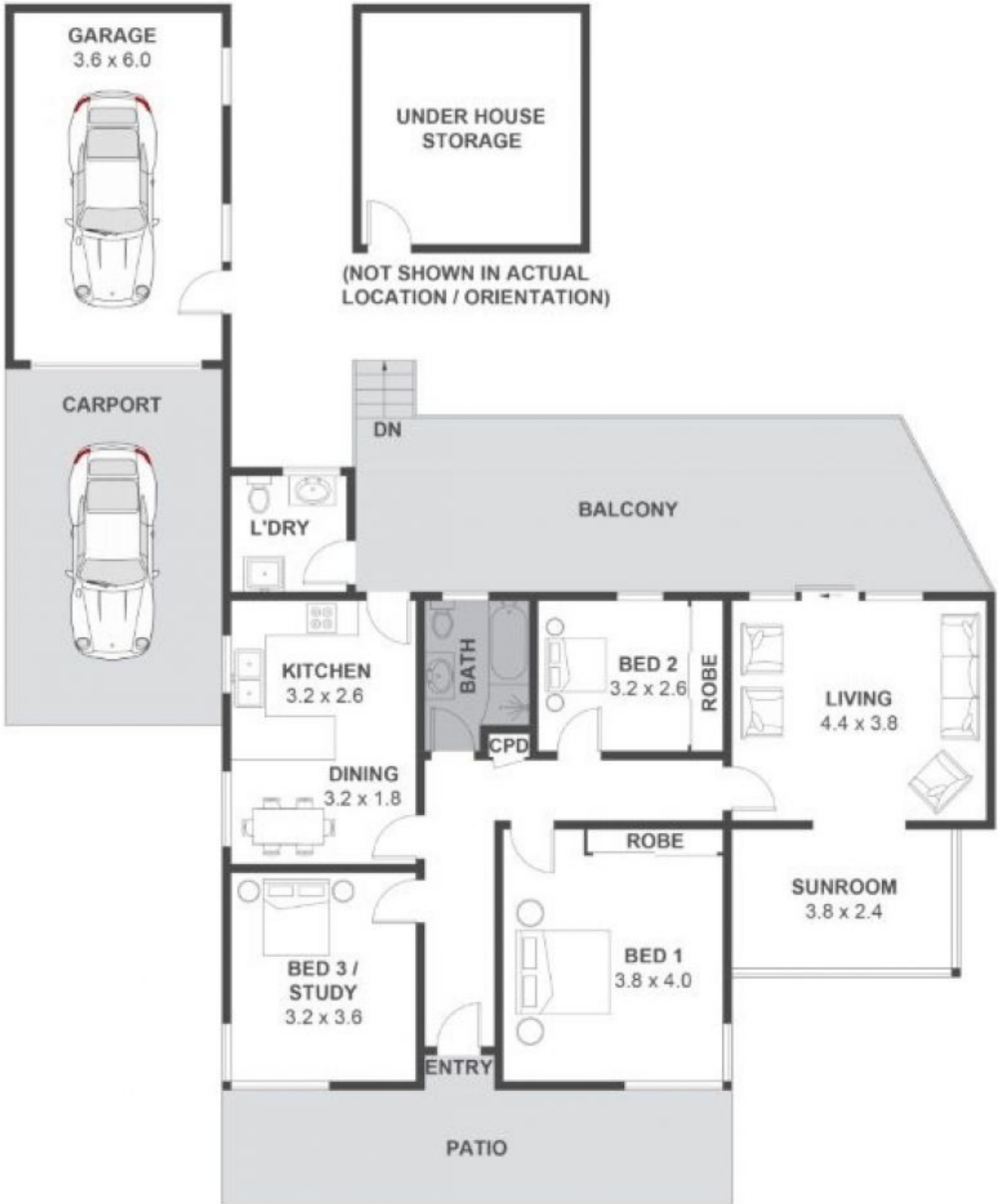

## 38 Buttenshaw Place, Austinmer

Internal Space 138.1m<sup>2</sup>



Scale in metres. Indicative only. Dimensions are approximate. All information contained herein is gathered from sources we believe to be reliable. However, we cannot guarantee its accuracy and interested persons should rely on their own enquiries. Some images may contain digital furniture.