



154/214-220 Princes Highway Fairy Meadow, NSW



## Love Your Loft Life

### The Home

Defined by its soaring ceilings, contemporary finishes and effortless sense of space, this striking loft-style apartment offers an exceptional entry into the property market or a smart opportunity for investors seeking strong returns in a consistently in-demand suburb.

Tucked away within a secure, resort-style complex, the home delivers low maintenance comfort with impressive architectural flair, all while being steps from vibrant shopping, transport and city centre.

- ? Soaring double-height ceilings enhance the feeling of space and light
  - ? Open-plan living and dining flowing to a private balcony - perfect for morning coffee or evening unwinding
  - ? Sleek contemporary kitchen with stone benchtops, gas cooking and breakfast bar
  - ? Loft-style master bedroom featuring built-in robe and elevated privacy
- Whether you're starting out, slowing down or searching for a lock-up-and-leave coastal base, this residence promi

**Price:** \$505,000.00  
**Council Rates:** \$228.52 p/q  
**Water Rates:** \$204.13 p/q  
**Strata Rates:** \$1,390.00 p/q

**Max Fairnie**

**Adam McMahon**

02 4267 5377

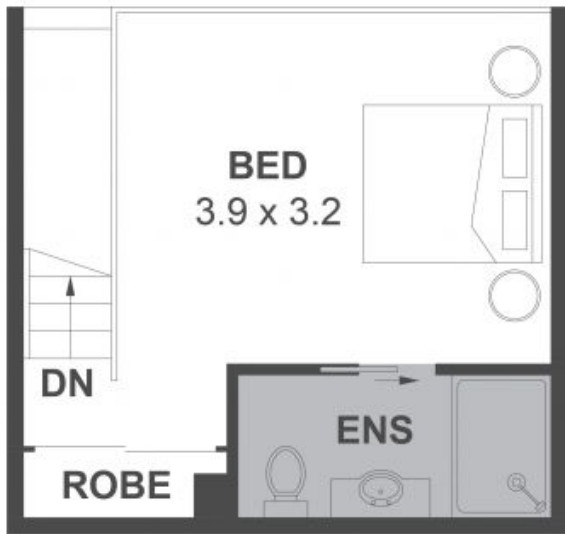

**UPPER LEVEL**

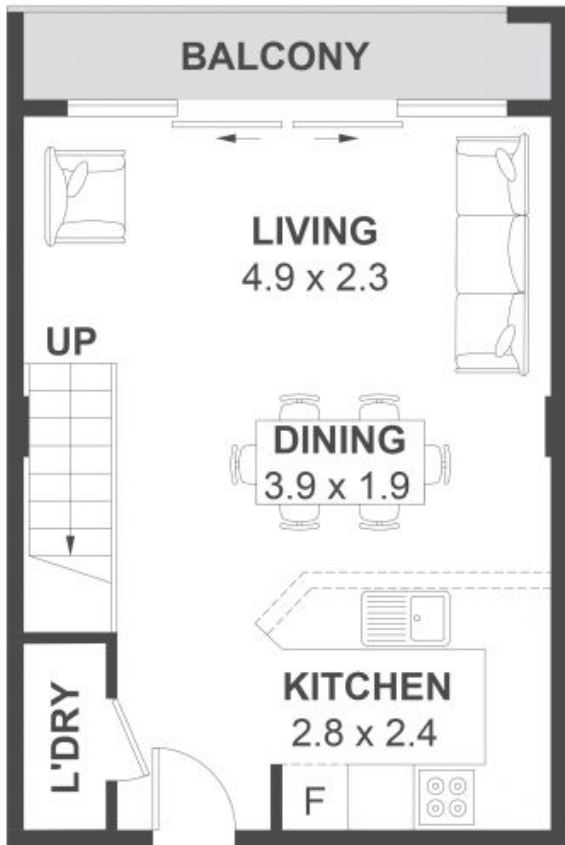

**LOWER LEVEL**



**DETACHED**

**(NOT SHOWN IN ACTUAL LOCATION / ORIENTATION)**

154/214-220 Princes Highway, Fairy Meadow Internal Space 53m<sup>2</sup>

Scale in metres. Indicative only. Dimensions are approximate. All information contained herein is gathered from sources we believe to be reliable. However, we cannot guarantee its accuracy and interested persons should rely on their own enquiries. Some images may contain digital furniture.