



12 Willow Grove Corrimal, NSW



## Elevated Elegance!

Commanding an elevated position in one of Corrimal's most tightly held pockets, this beautifully renovated residence delivers a rare sense of scale, privacy and polish. Thoughtfully reimagined to embrace light, outlook and effortless entertaining, the home unfolds across generous proportions with an emphasis on quality, comfort and connection to its lush surrounds.

**Price:** \$1,600,000  
**Council Rates:** \$594.00 p/q  
**Water Rates:** \$300.00 p/q

### The Home

- Expansive open-plan living and dining zones enhanced by warm timber flooring, plantation shutters and abundant natural light
- Statement kitchen forming the social heart of the home, appointed with stone benchtops, premium appliances and a substantial island designed for gathering
- Separate alfresco pavilion overlooking manicured gardens and level lawn, creating a private, resort-inspired se

**Ethan Hennessy**

**Shawn Condello**

02 4267 5377



FIRST FLOOR

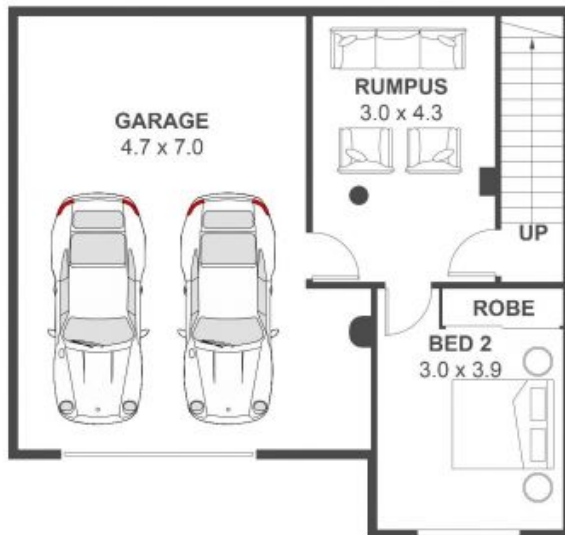

GROUND FLOOR

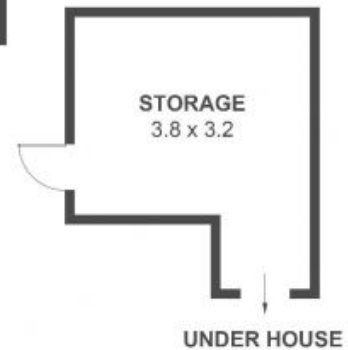

(NOT SHOWN IN ACTUAL LOCATION / ORIENTATION)

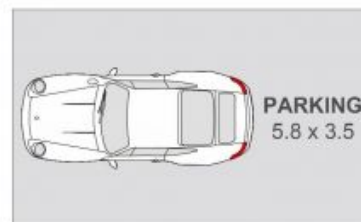

(NOT SHOWN IN ACTUAL LOCATION / ORIENTATION)

# 12 Willow Grove, Corrimal

Internal Space 217.1m<sup>2</sup>



Scale in metres. Indicative only. Dimensions are approximate. All information contained herein is gathered from sources we believe to be reliable. However, we cannot guarantee its accuracy and interested persons should rely on their own enquiries. Some images may contain digital furniture.